

**TECHNICAL DATA:**

Not easily accessible device,  
according to standard EN 1176-1:2017

- Device dimensions: 9,25 x 8,25 m
- Device height: 3,70m
- Minimum space: 12,40 x 11,29m
- Falling area: 127,64 m<sup>2</sup>
- Critical fall height: 2,20 m
- Foundations depth: -0,60m

**Top view with impact area**

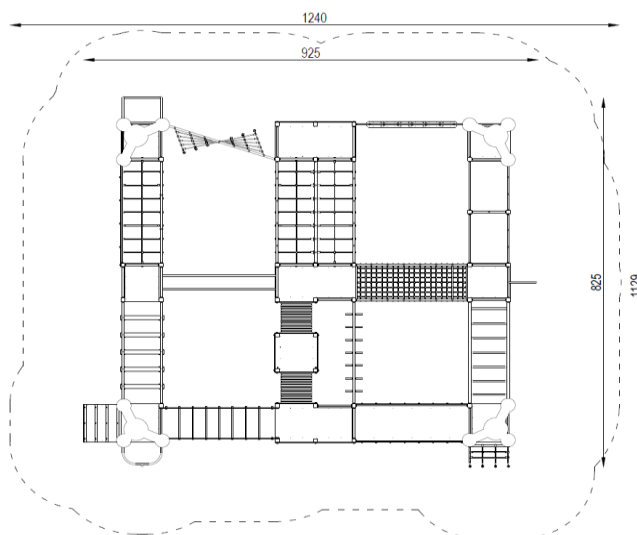

The device according to EN 1176-1:2017  
Playground equipment and surfacing – Part 1:  
General safety requirements and test methods

- Safety surfaces:
- sand, gravel, bark, synthetic surface
  - minimal thickness for loose particulate materials 200+100mm
  - synthetic surface according to critical fall height

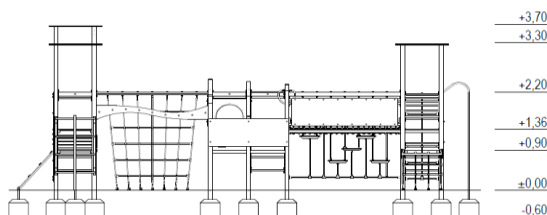

**COMPONENTS:**

Single tower with roof, platform 120cm	3 pcs
Single tower with roof, platform 90cm	3 pcs
Duble tower without roof, platform 136cm	2 pcs
Duble tower without roof, platform 90cm	1 pc
Arched ladder 228cm	1 pc
Bridge with platform	1 pc
Climbing ropes 220 cm 2	
Diagonal entry ropenet	1 pc
Diagonal rope bridge 228cm	1 pc
Diagonal, entry gangplank 60cm	1 pc
Duble fireman's pole with ladder 136 cm	1 pc
Duble raising bar	1 pc
Efficiency vertical ropes	1 pc
Fireman's pole 136cm	1 pc
Fireman's pole with ladder 90 cm	1 pc
Horizontal ladder 228cm	1 pc
Narrow horizontal rope net	1 pc
Narrow vertical ropenet 220 cm	1 pc
Raising bar	2 pcs
Raising bar 228cm	1 pc
Rectilinear twisted net 220 cm	1 pc
Rope bridge 228 cm	1 pc
Rope net height 180 cm	1 pc
Rope net with stairs height 150 cm	1 pc
Tunnel 228 cm	1 pc
Vertical ladder- 1 grade	3 pcs
Vertical ladder- 3 grades 5	5 pcs
Wide climbing wall 220 cm	1 pc
Wide horizontal rope net	1 pc
Wide vertical ropenet 200 cm	1 pc

**MATERIALS:**

Construction poles:	steel square profiles, galvanized, powder coated in gray
Flat decorative elements:	HDPE sheets
Platforms, gangways:	waterproof plywood, with anti-slip layer, based on steel structure
Steel elements:	galvanized steel, powder coated
Ropes:	polypropylene braided with a steel, interconnected by plastic fasteners
Surface of slide:	stainless steel
Climbing walls:	waterproof plywood, climbing grips based on resins
Caps:	plastic
Foundations:	concrete min. C12/15 standard



SATERNUS DISTRIBUTION Sp. z o.o. sp.k.  
ul. Nowa 32  
41-500 Chorzów, Poland

Certificate beholder:  
Producer:  
Distributor:

GRUPA SATERNUS Sp. z o.o. S. K. A. reserves all rights to protect copyright under the Act of February 4, 1994 on Copyright and Related Rights (Journal of Laws No. 28, pc 83), and in particular Art. 78 and 79 of this Law.

GRUPA SATERNUS Sp. z o.o. S. K. A.  
Saternus Production Sp. z o.o. sp. k.  
Saternus Distribution Sp. z o.o. sp. k.