



## TECHNICAL DATA:

Easily accessible device,  
according to standard EN 1176-1:2017

Device dimensions: 1,71 x 0,75m  
 Device height: 1,25m  
 Minimum space: 3,15 x 2,61m  
 Falling area: 7,40m<sup>2</sup>  
 Critical fall height: 0,45m  
 Foundations depth: -0,60m

The device according to EN 1176-1:2017  
 Playground equipment and surfacing – Part 1:  
 General safety requirements and test methods

Safety surfaces:  
 - sand, gravel, bark, synthetic surface  
 - minimal thickness for loose particulate materials 300+100mm  
 - synthetic surface according to critical fall height

## Projection and side view

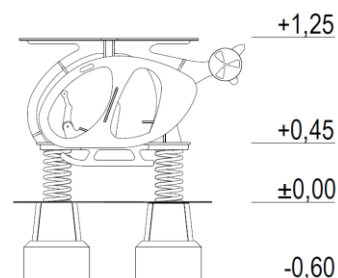
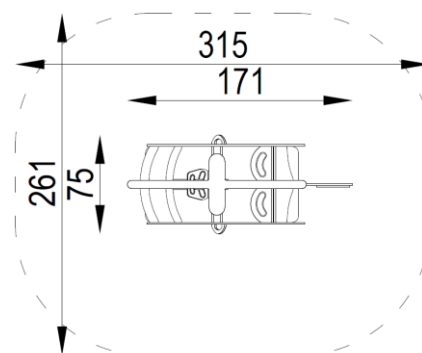

## MATERIALS:

Whole device:	HDPE sheets
Spring:	galvanized steel, powder coated
Steel elements:	galvanized steel, powder coated
Connections:	stainless steel machine bolts
Caps:	plastic
Foundation base:	openwork steel construction
Foundations:	concrete min. C12/15 standard



GRUPA SATERNUS S.A.  
ul. Nowa 32  
41-500 Chorzów, Poland

Certificate beholder:  
Producer:  
Distributor:

GRUPA SATERNUS S.A. reserves all rights to protect copyright  
Under the Act of February 4, 1994 on Copyright and Related Rights  
(Journal of Laws No. 28, pc 83), and in particular Art. 78 and 79 of this Law.

GRUPA SATERNUS S.A.  
Saternus Production Sp. z o.o. sp. k.  
Saternus Distribution Sp. z o.o. sp. k.